



# DESIGNED FOR AN EASY LIFESTYLE

*Lot 702 Courtney Loop*



Illustrative purposes only



## \$715,900

4 2 2

### FEATURE INCLUSIONS

- ✓ Meticulous newly built home with the highest quality workmanship & inclusions throughout
- ✓ Ducted Reverse Cycle Air Conditioning
- ✓ 20mm Caesarstone to kitchen bench tops
- ✓ Soft close hinges to kitchen drawers and cupboards
- ✓ 900mm Westinghouse Stainless Steel Appliances
- ✓ Dishwasher included
- ✓ Tiles to living areas and carpets to bedrooms
- ✓ Flush panel internal doors
- ✓ Vertical blinds throughout
- ✓ Insulation to walls and ceilings
- ✓ T2 Termite Resistant roof trusses and wall frames
- ✓ 'Coloured On' Concrete Driveway + remote garage
- ✓ Land Size 350m<sup>2</sup>
- ✓ Currently leased for \$550 per week



**Brolen Homes**

[brolenhomes.com.au](http://brolenhomes.com.au)



DISCLAIMER: All images and drawings including landscape plans are for illustrative purposes only, & should be used as a guide only. Purchasers are advised to refer to the Land Contract and or Builders Tender and Contract for precise dimensions, specifications and inclusions. Brolen Homes reserves the right to revise plans, specifications, materials and suppliers without notice. B.L. 268214C

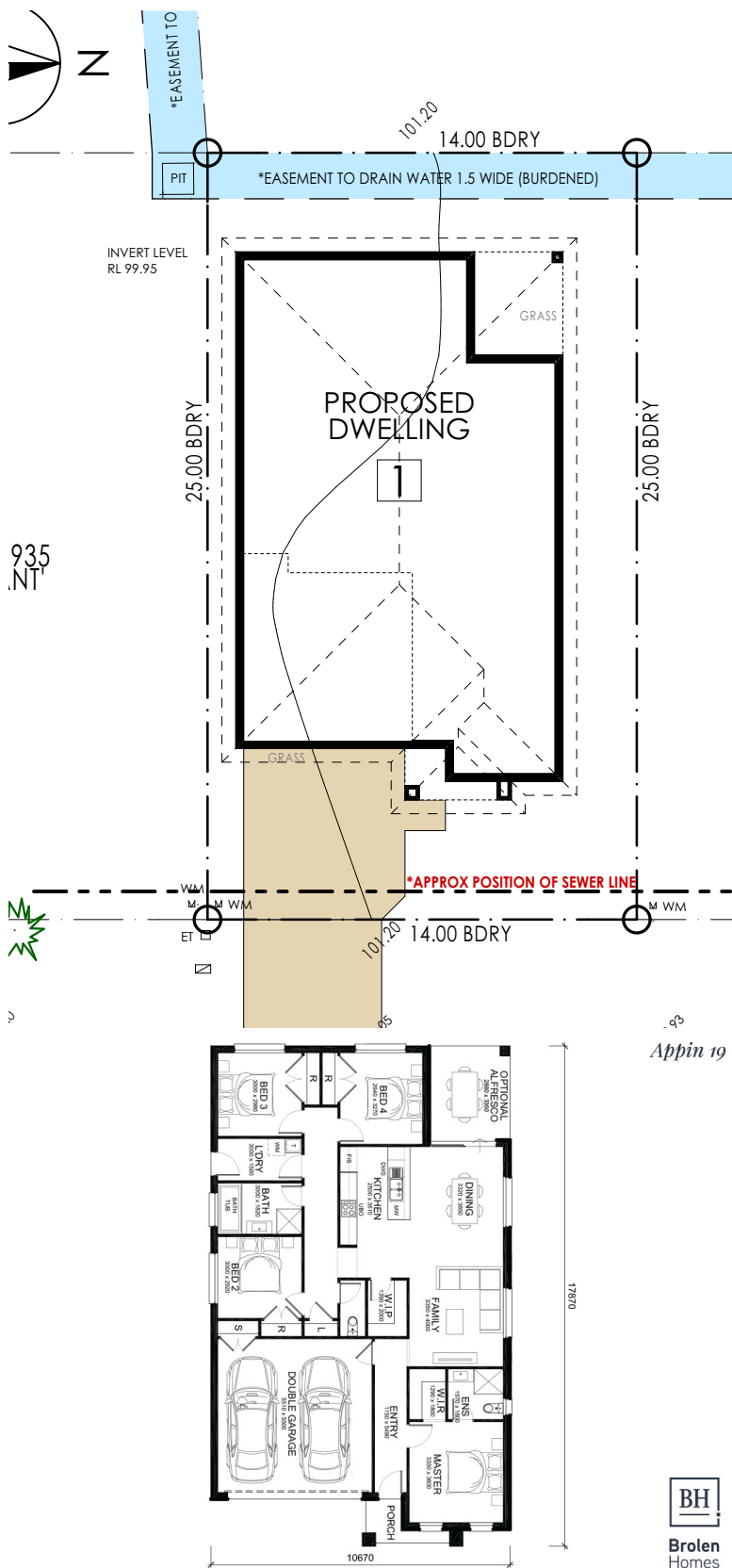

**Display Home Open**  
**19 Webber Loop, Oran Park**  
 View Thursday - Monday 10am - 5pm



**Brolen Homes**

George 0449 196 136  
 sales@brolenhomes.com.au  
 www.brolenhomes.com.au